



milwaukee M18 BBL Compact Blower User Manual

[Home](#) » [Milwaukee](#) » milwaukee M18 BBL Compact Blower User Manual 



Nothing but HEAVY DUTY.™

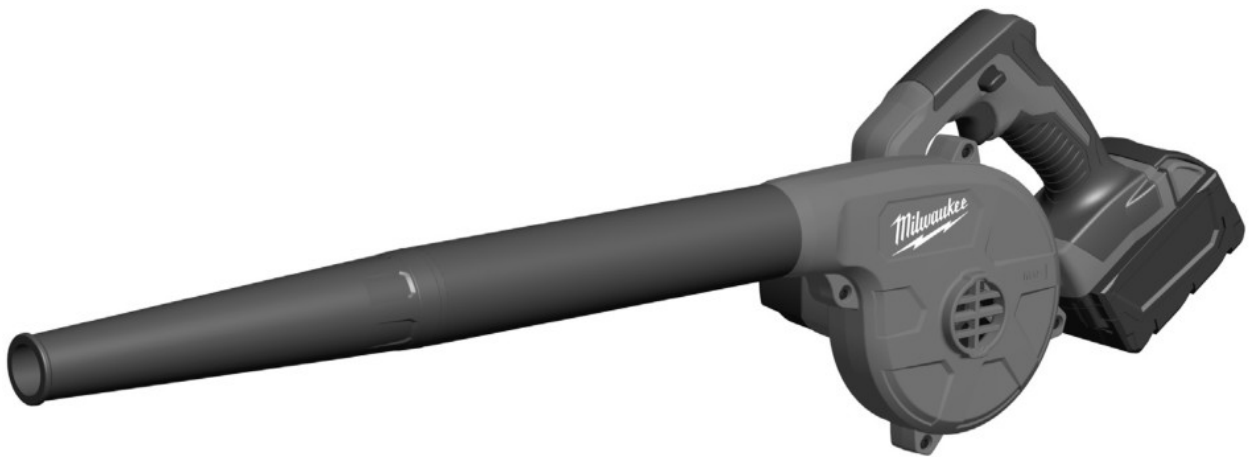

**M18 BBL
User Manual**

Contents

- 1 M18 BBL Compact Blower
- 2 TECHNICAL DATA
- 3 SAFETY INSTRUCTIONS
- 4 SPECIFIED CONDITIONS OF USE
- 5 BATTERIES
- 6 MAINTENANCE
- 7 SYMBOLS
- 8 Documents / Resources
- 9 Related Posts

M18 BBL Compact Blower

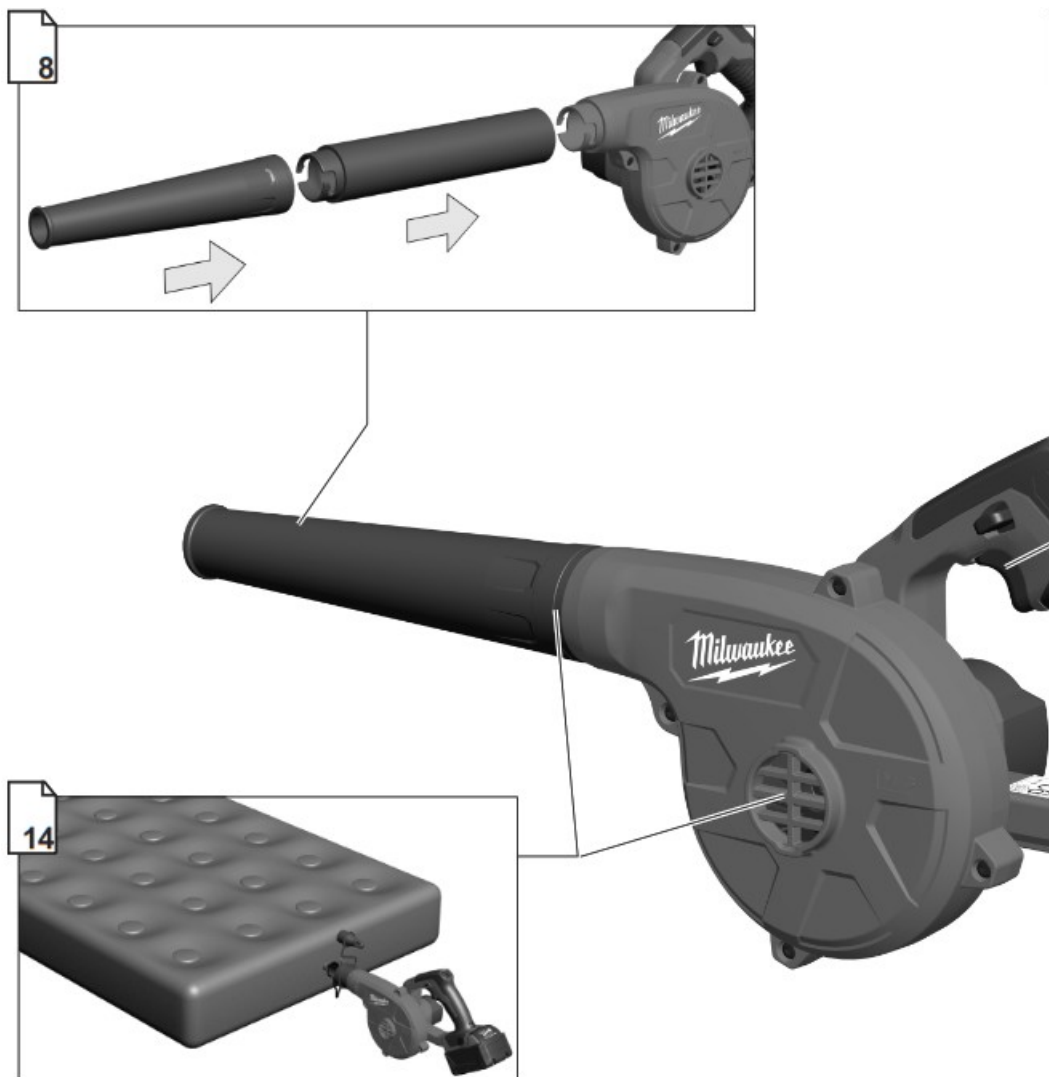

Remove the battery pack before starting any work on the machine.

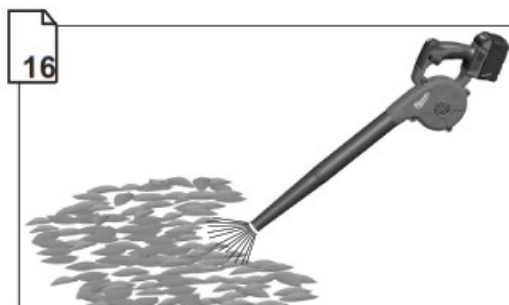
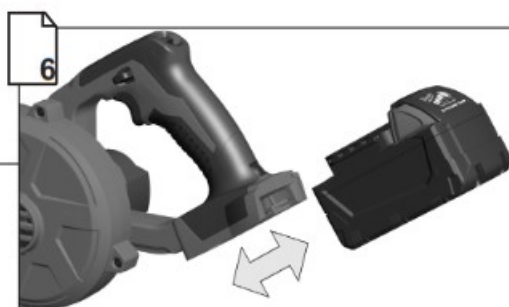
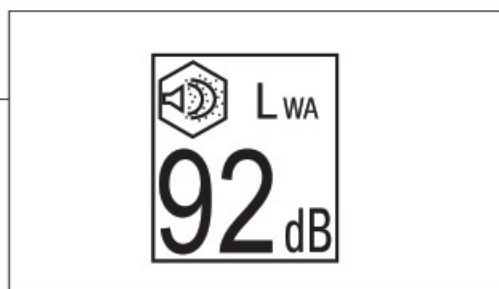
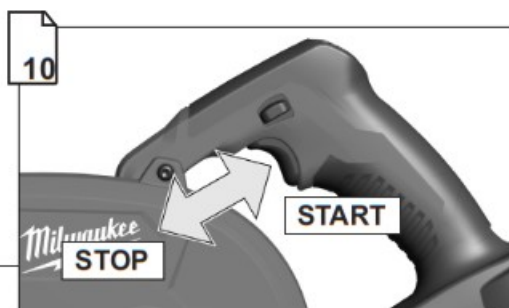

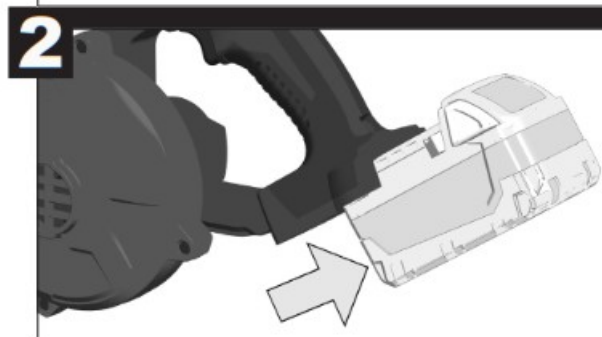
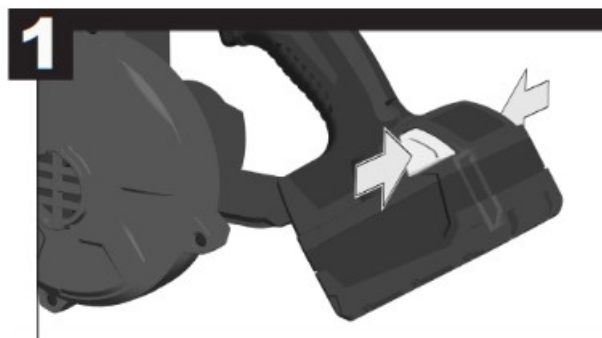
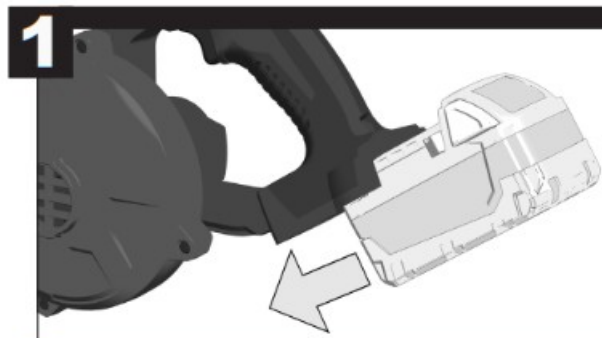
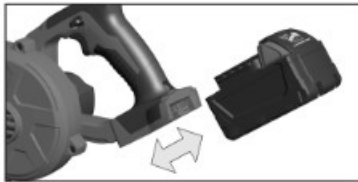

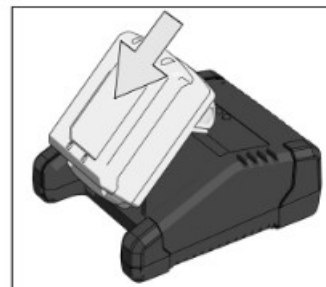
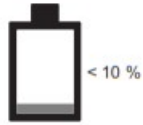
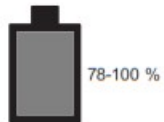
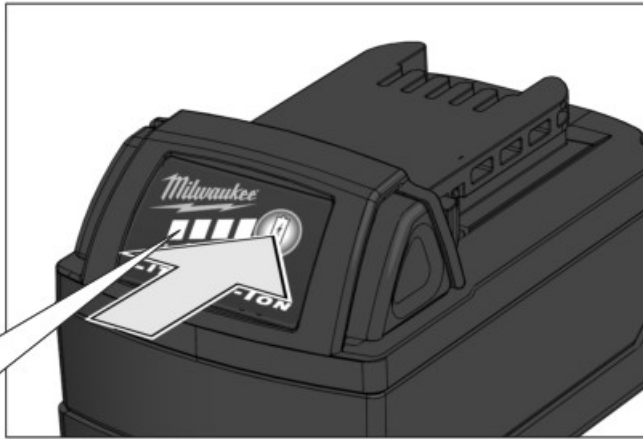

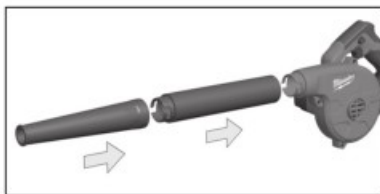

1

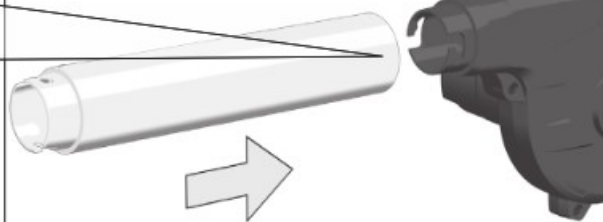
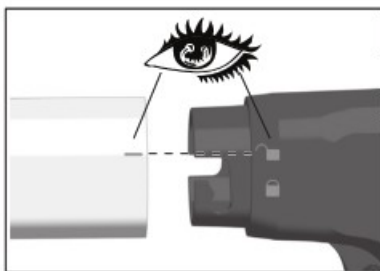

2

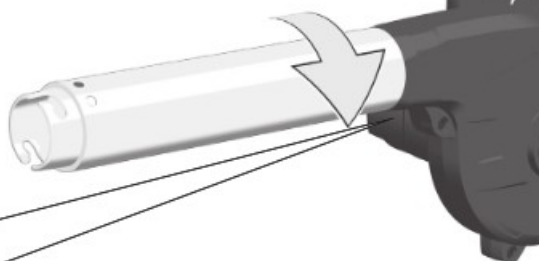
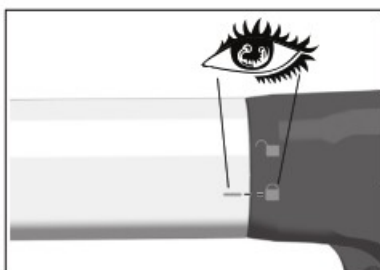

3

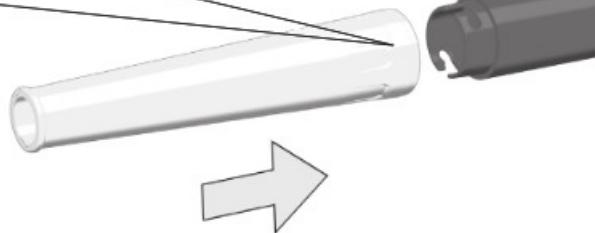
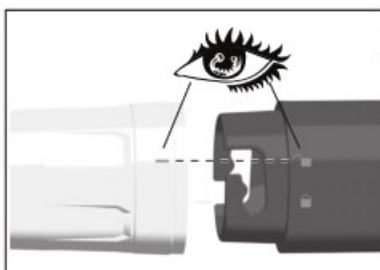

4

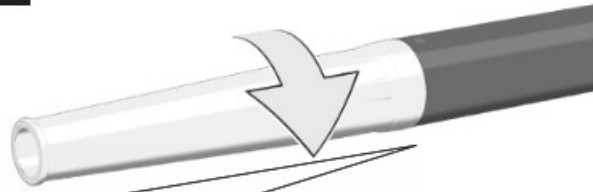
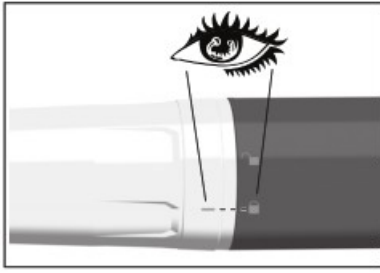



START



STOP



START/LOCK

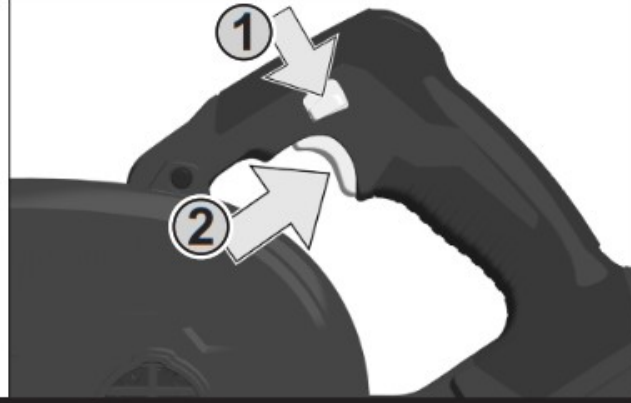

STOP

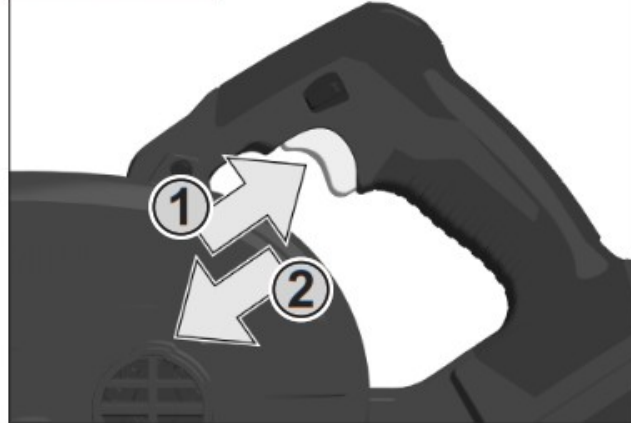

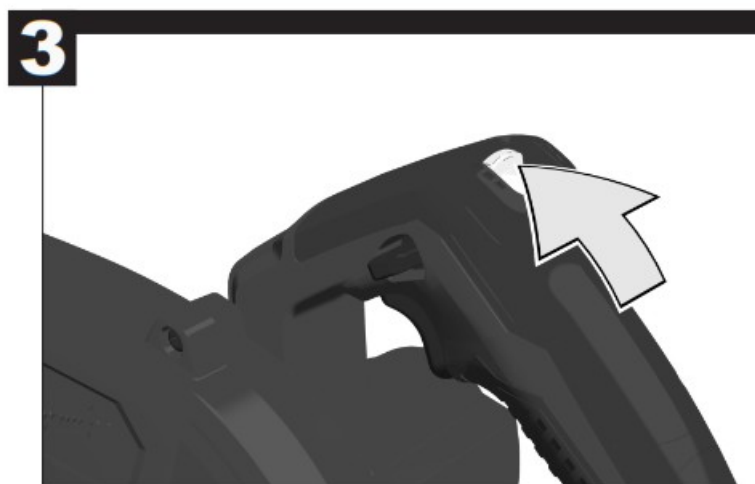
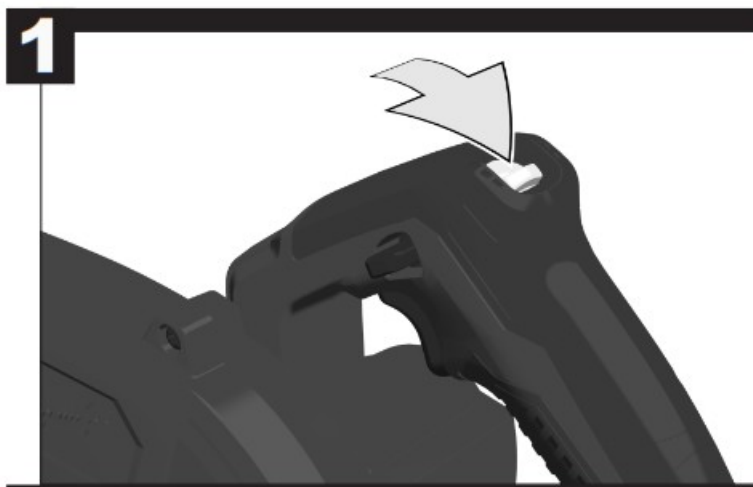

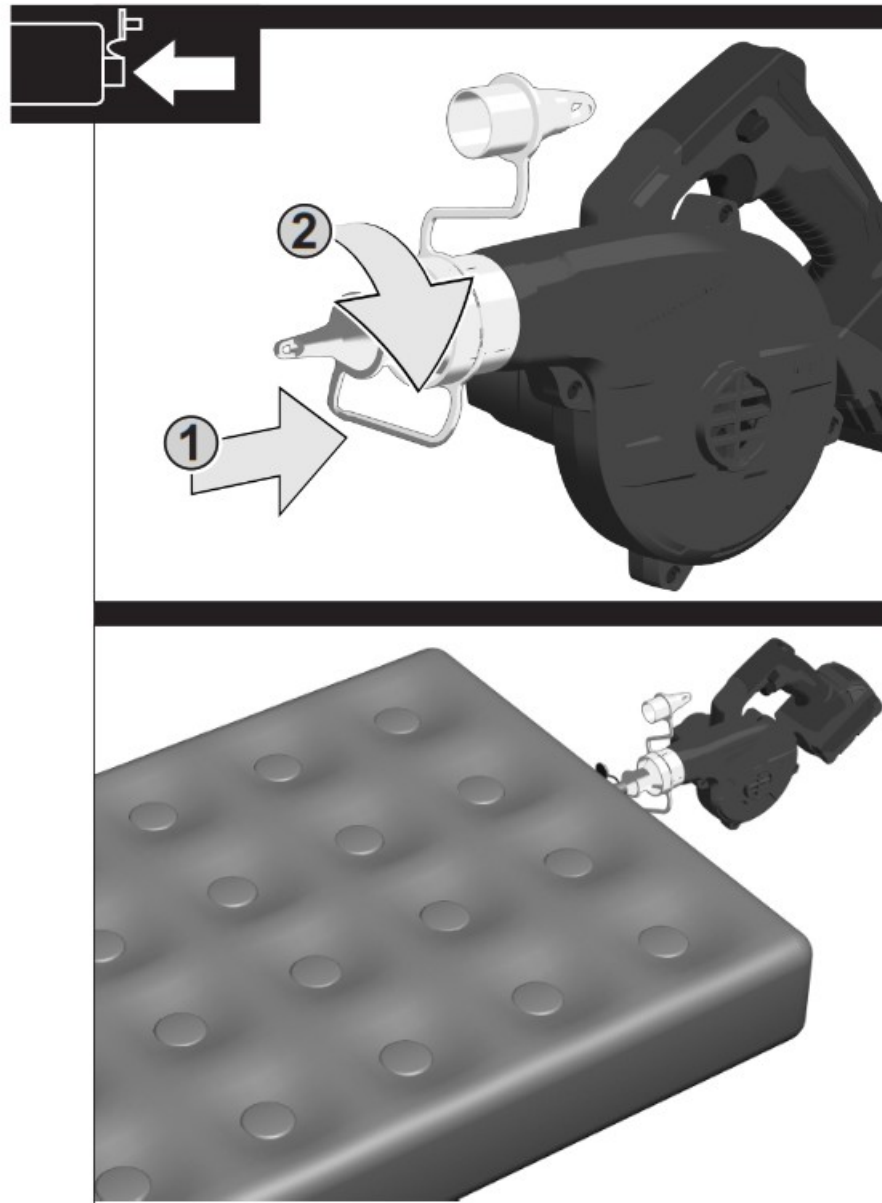
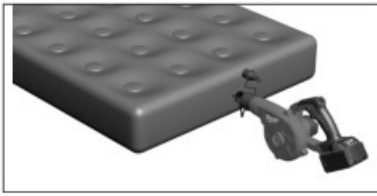

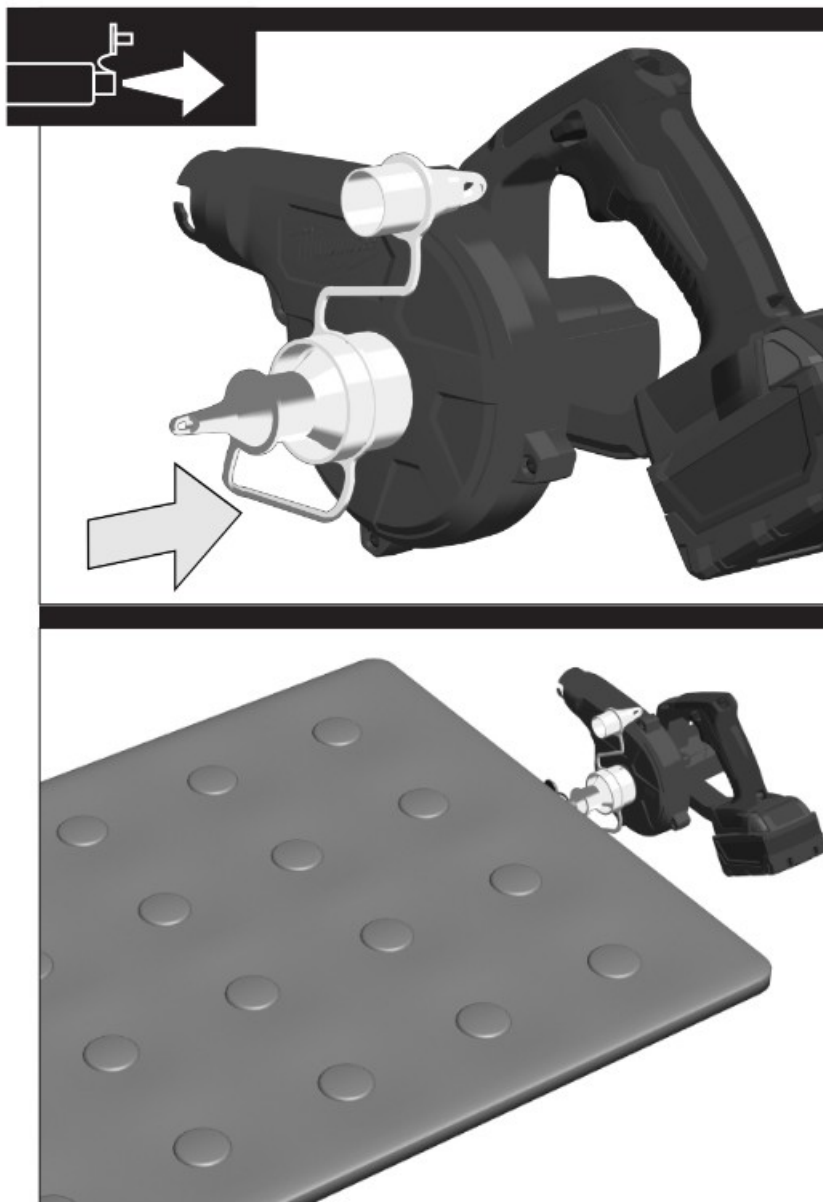

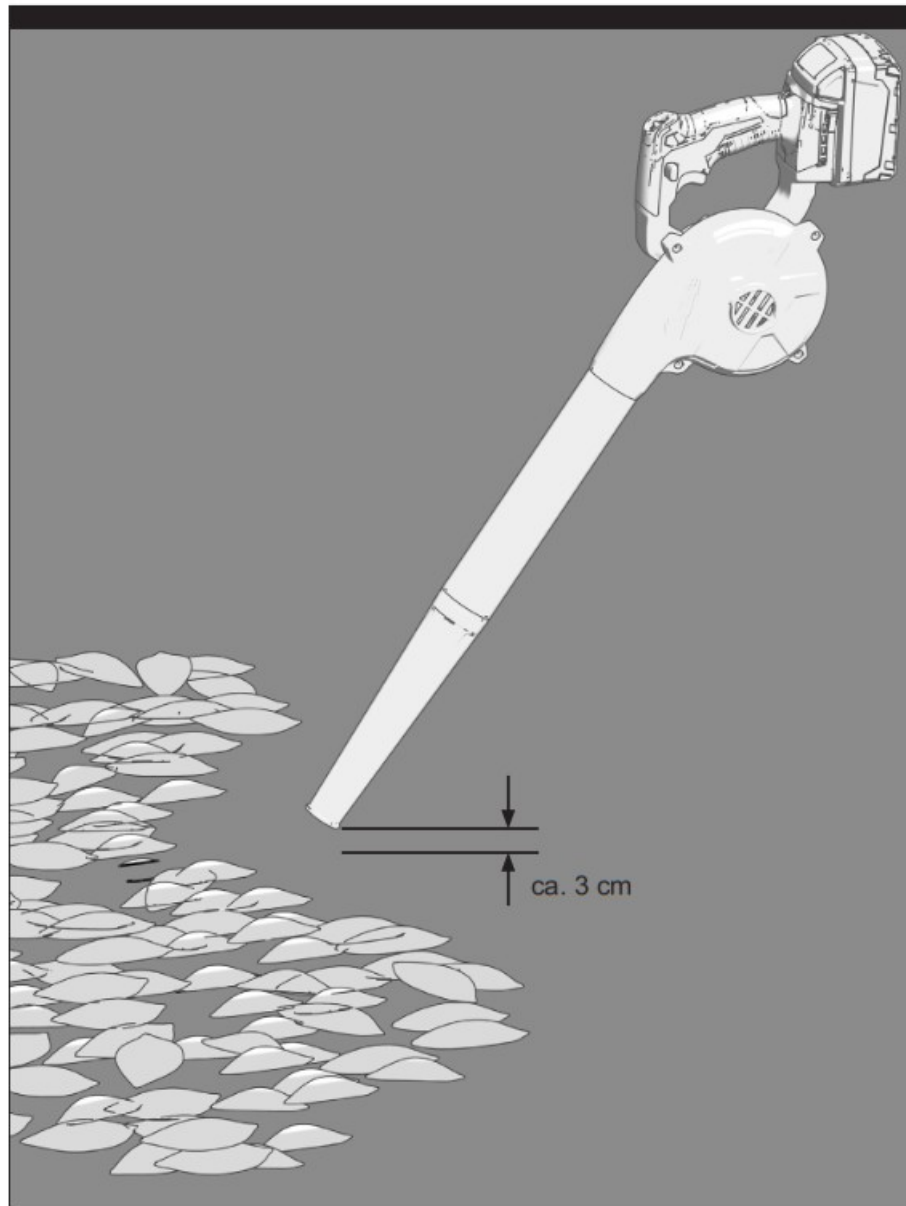
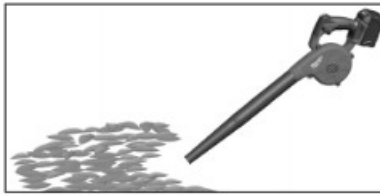

Do not use for sucking!

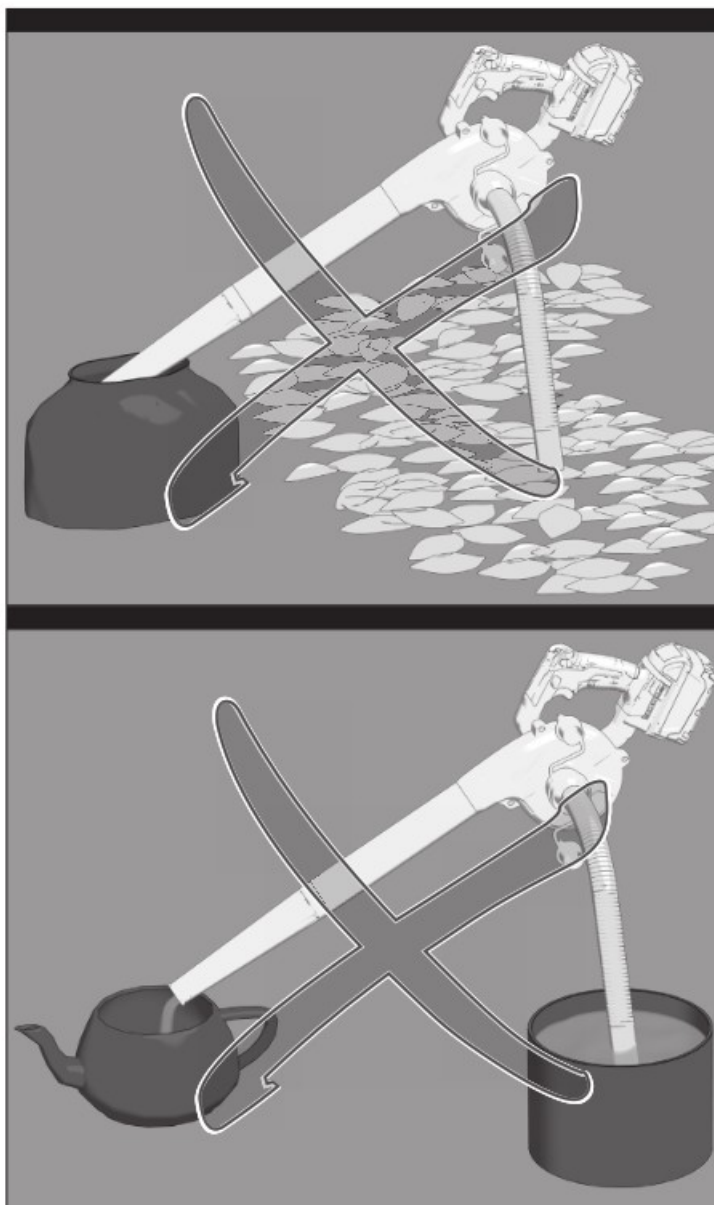

TECHNICAL DATA

M18 BBL

Rated input.....15 A

No-load speed

- Level 1.....18700 min⁻¹
- Level 2.....0-15300 min⁻¹
- Level 3.....0-11500 min⁻¹

Air speed max

- Level 1.....257 km/h
- Level 2.....225 km/h
- Level 3.....161 km/h

Air flow rate

- Level 1.....2,9 m³/min
- Level 2.....2,4 m³/min
- Level 3.....1,8 m³/min

Battery voltage.....18 V

Weight according EPTA-Procedure 01/2003 (with Li-Ion battery 3.0 Ah).....1,9 kg

Weight according EPTA-Procedure 01/2003 (with Li-Ion battery 4.0 Ah).....1,9 kg

Noise/vibration information

Measured values determined according to EN 60 745.

Typically, the A-weighted noise levels of the tool are:

Sound pressure level (K = 3 dB(A)).....77,7 dB(A)

Sound power level (K = 3 dB(A)).....89,6 dB(A)

Wear ear protectors!

Total vibration values (vector sum in the three axes) determined according to EN 60745.

Vibration emission value ah.....3,0 m/s²

Uncertainty K.....1.5 m/s²



WARNING!

The vibration emission level given in this information sheet has been measured in accordance with a standardised test given in EN 60745 and may be used to compare one tool with another. It may be used for a preliminary assessment of exposure.

The declared vibration emission level represents the main applications of the tool. However if the tool is used for different applications, with different accessories or poorly maintained, the vibration emission may differ. This may significantly increase the exposure level over the total working period.

An estimation of the level of exposure to vibration should also take into account the times when the tool is switched off or when it is running but not actually doing the job. This may significantly reduce the exposure level over the total working period.

Identify additional safety measures, such as maintaining the tool and the accessories, keeping the hands warm, and organising work patterns, to protect the operator from the effects of vibration.



WARNING!

Read all safety warnings and all instructions, including those given in the accompanying brochure. Failure to follow the warnings and instructions may result in electric shock, fire and/or serious injury.

Save all warnings and instructions for future reference.

SAFETY INSTRUCTIONS

The product is not intended to be used by persons (including children) with limited physical, sensory, or mental capabilities or insufficient experience and/or knowledge, unless they are supervised by a person who is responsible for their safety or have been instructed by them in the safe use of the appliance.

Children should be supervised in order to ensure that they do not play with the product.

Children should not use, clean, or play with the product. When not in use, store the product out of the reach of children.

Dress properly. Do not wear loose clothing or jewellery.

Keep your hair, clothing and gloves away from moving parts. Loose clothes, jewellery, or long hair can be caught in moving parts.

Failure to keep loose clothing, jewellery, and long hair from being drawn into air intake could result in personal injury.

Do not overreach. Keep proper footing and balance at all times, especially in slopes.

Walk, never run.

Never blow debris in the direction of bystanders.

Do not operate without the tubes in place.

Use the provided adapter to inflate or deflate air beds.

Keep all cooling air inlets clear of dirt.

Do not modify the product in any way. Unauthorized modifications may impair the safety of your product and may result in increased noise and vibration.

Store the appliance only in a dry place.

Remove the battery pack before starting any work on the product.

Do not dispose of used battery packs in the household refuse or by burning them. Milwaukee Distributors offer to retrieve old batteries to protect our environment.

Do not store the battery pack together with metal objects (short circuit risk).

Use only System C18 chargers for charging System C18 battery packs. Do not use battery packs from other systems.

Battery acid may leak from damaged batteries under extreme load or extreme temperatures. In case of contact with battery acid wash it off immediately with soap and water. In case of eye contact rinse thoroughly for at least 10 minutes and immediately seek medical attention.

SPECIFIED CONDITIONS OF USE

The cordless blower may be used as follows:

- blowing of dirt and leaves
- inflate air bed
- deflate air bed

Do not use this product in any other way as stated for normal use.

BATTERIES

New battery packs reach full loading capacity after 4 – 5 chargings and dischargings. Battery packs which have not been used for some time should be recharged before use.

Temperatures in excess of 50°C (122°F) reduce the performance of the battery pack. Avoid extended exposure to heat or sunshine (risk of overheating).

The contacts of chargers and battery packs must be kept clean.

For an optimum life-time, after use, the battery packs have to be fully charged.

To obtain the longest possible battery life, remove the battery pack from the charger once it is fully charged.

For battery pack storage longer than 30 days:

- store the battery pack where the temperature is below 27°C and away from moisture
- store the battery packs in a 30% – 50% charged condition

Every six months of storage, charge the pack as normal.

MAINTENANCE

Tighten all nuts, bolts, and screws to be sure that the machine is in safe working condition.







Examine the machine and replace worn or damaged parts for safety.

Use only Milwaukee accessories and Milwaukee spare parts.

Should components need to be replaced which have not been described, please contact one of Milwaukee service agents.

If needed, an exploded view of the tool can be ordered. Please state the machine type printed as well as the six-digit No. on the label and order the drawing at your local service agents.

SYMBOLS

	Please read the instructions carefully before starting the machine.
	Remove the battery pack before starting any work on the machine.
	Wear goggles.
	Wear ear protectors.
	Wear dust mask.
	Keep bystanders a safe distance away from the machine.
	Pay attention that bystanders are not injured through foreign objects thrown from the product.
	Do not use in the rain or leave outdoors while it is raining.
	Noise according to 2000/14/EC
	Do not dispose of electric tools together with household waste material! In observance of European Directive 2002/96/EC on waste electrical and electronic equipment and its implementation in accordance with national law, electric tools that have reached the end of their life must be collected separately and returned to an environmentally compatible recycling facility.

Documents / Resources

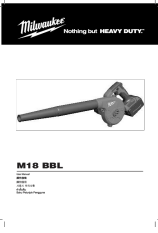
 <p>Milwaukee Nothing but HEAVY DUTY</p> <p>M18 BBL</p> <p>Model: 48-11-180 Voltage: 18V Power: 1800W Weight: 4.5kg</p>	<p>milwaukee M18 BBL Compact Blower [pdf] User Manual</p> <p>M18 BBL Compact Blower, M18 BBL, Compact Blower, Blower</p>
--	--